

MUMBAI 452

One Bedroom, One Bath

Interior: 452 sq.ft. | Exterior: 100 sq.ft.

Total: 552 sq.ft.

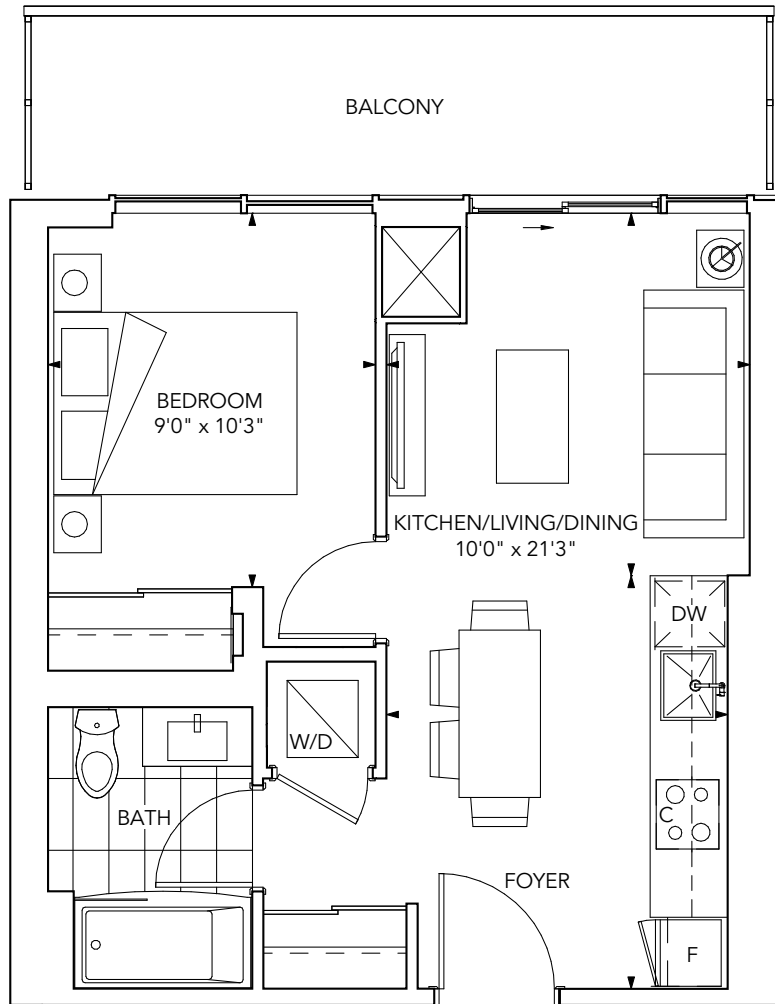

Typical Floor | Tower C

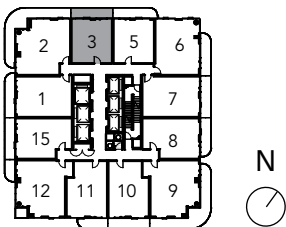

*Prices, sizes and specifications subject to change without notice. E.&O.E. The dimensions shown of this plan are approximate and subject to normal construction variances. Actual useable floor space within the unit may vary from any stated floor areas or dimensions on this plan. Furniture is displayed for illustration purposes only and does not necessarily reflect the electrical plan for the suite. Suites are sold unfurnished. For more information on the method used for calculating the floor area of any unit, reference should be made to Builder Bulletin No. 22 published by Tarion.



MUMBAI 452 (R)

One Bedroom, One Bath

Interior: 452 sq.ft. | Exterior: 100 sq.ft.

Total: 552 sq.ft.

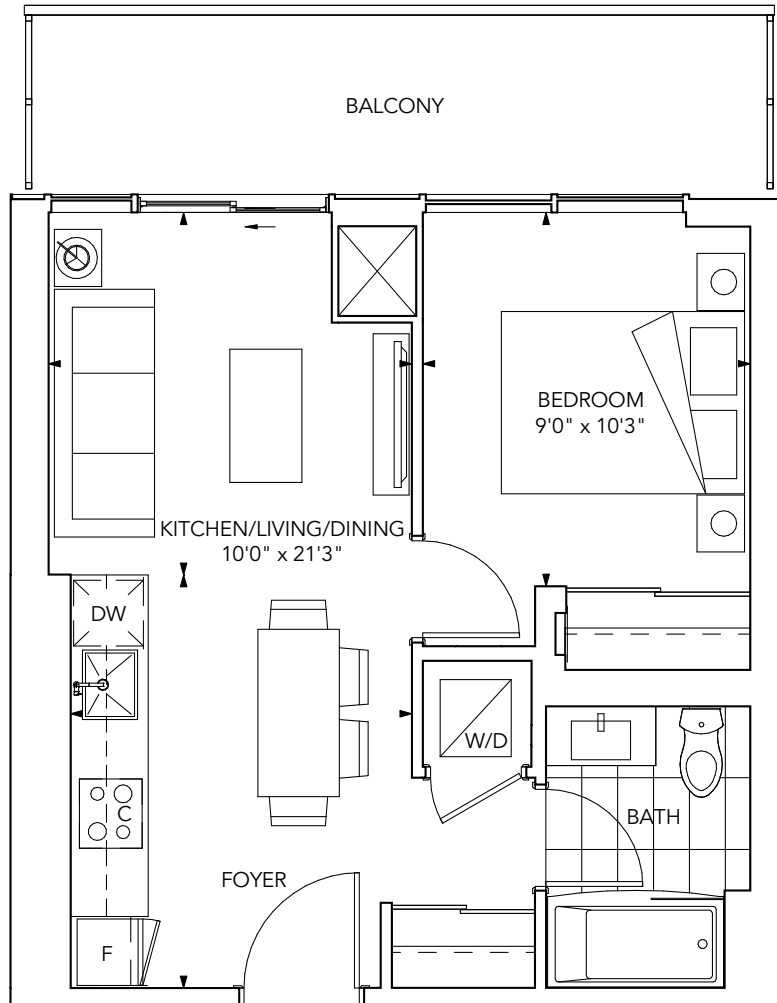

Typical Floor | Tower C

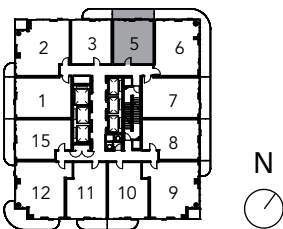

*Prices, sizes and specifications subject to change without notice. E.&O.E. The dimensions shown of this plan are approximate and subject to normal construction variances. Actual useable floor space within the unit may vary from any stated floor areas or dimensions on this plan. Furniture is displayed for illustration purposes only and does not necessarily reflect the electrical plan for the suite. Suites are sold unfurnished. For more information on the method used for calculating the floor area of any unit, reference should be made to Builder Bulletin No. 22 published by Tarion.



SYDNEY 540

One Bedroom + Den, One Bath

Interior: 540 sq.ft. | Exterior: 53 sq.ft.

Total: 593 sq.ft.

GRAND

FESTIVAL
South VMC

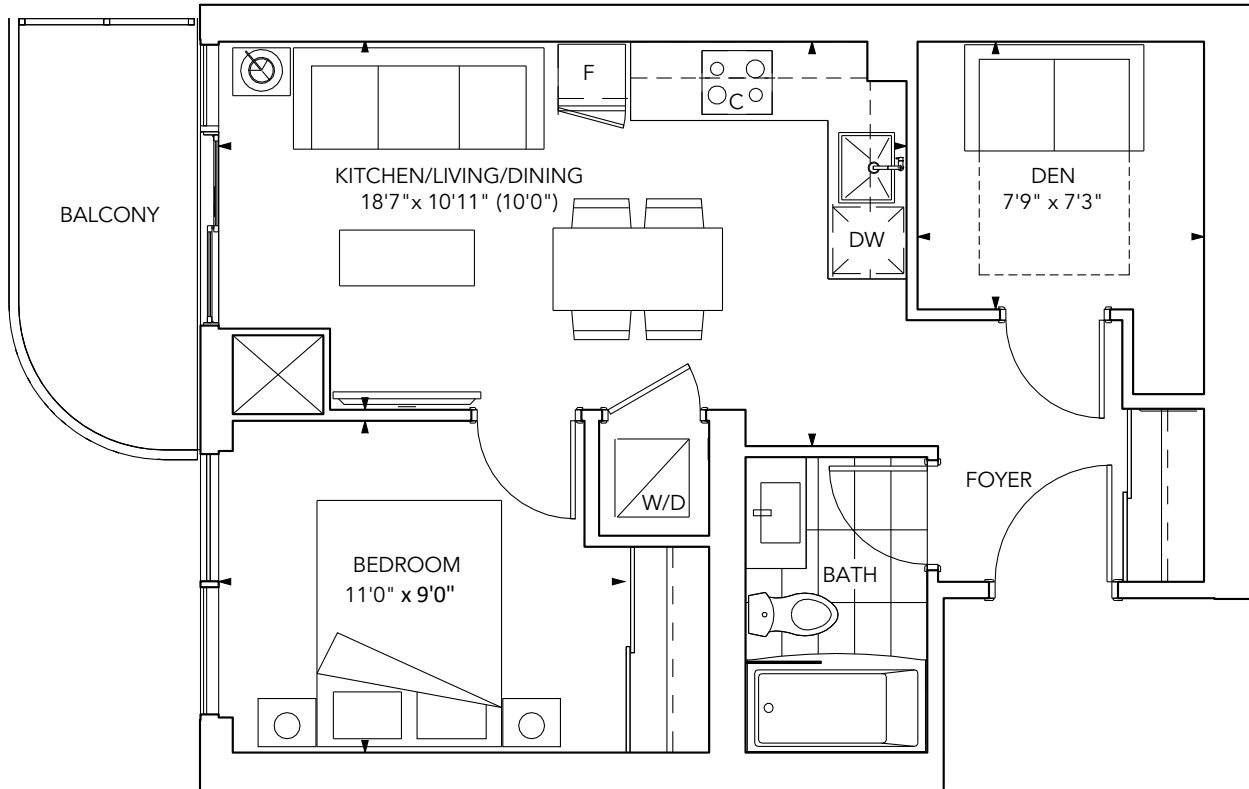

Typical Floor | Tower C

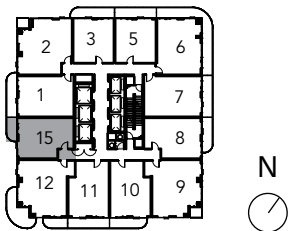

*Prices, sizes and specifications subject to change without notice. E.&O.E. The dimensions shown of this plan are approximate and subject to normal construction variances. Actual useable floor space within the unit may vary from any stated floor areas or dimensions on this plan. Furniture is displayed for illustration purposes only and does not necessarily reflect the electrical plan for the suite. Suites are sold unfurnished. For more information on the method used for calculating the floor area of any unit, reference should be made to Builder Bulletin No. 22 published by Tarion.



SYDNEY 543

One Bedroom + Den, One Bath
Interior: 543 sq.ft. | Exterior: 100 sq.ft.
Total: 643 sq.ft.

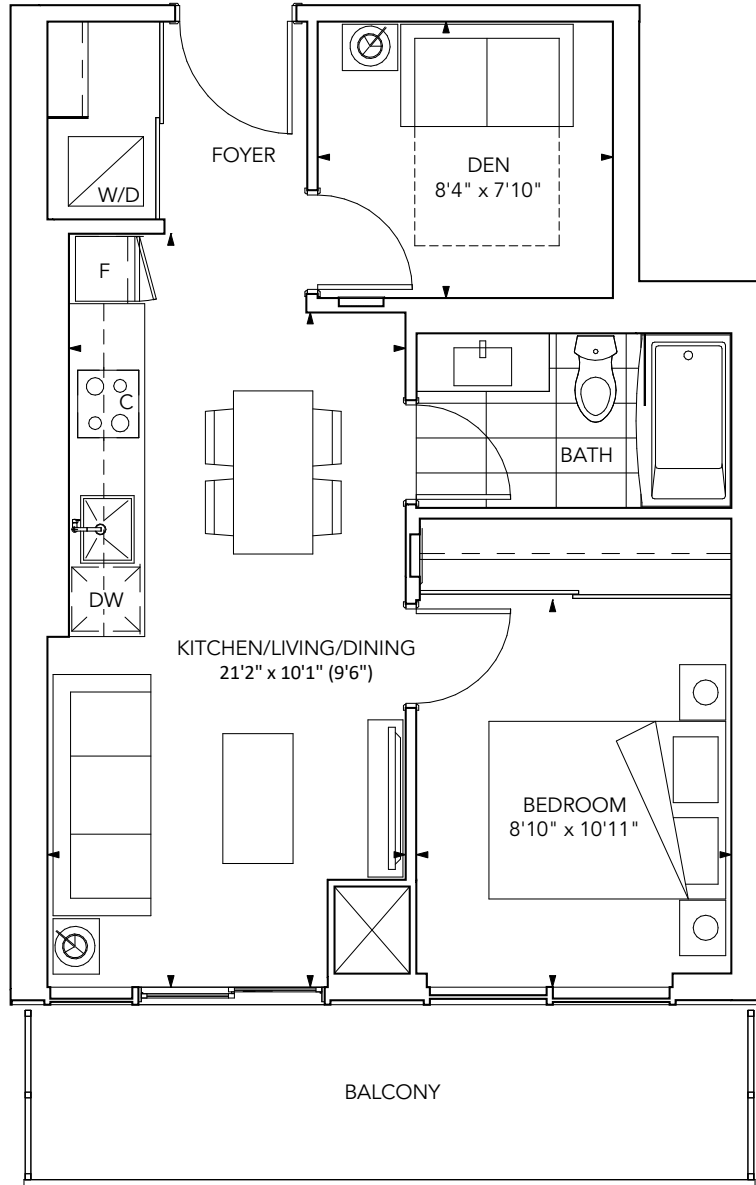

Typical Floor | Tower C

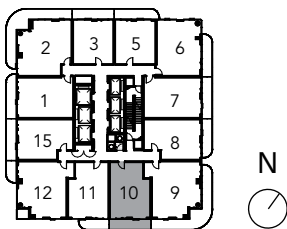

*Prices, sizes and specifications subject to change without notice. E.&O.E. The dimensions shown of this plan are approximate and subject to normal construction variances. Actual useable floor space within the unit may vary from any stated floor areas or dimensions on this plan. Furniture is displayed for illustration purposes only and does not necessarily reflect the electrical plan for the suite. Suites are sold unfurnished. For more information on the method used for calculating the floor area of any unit, reference should be made to Builder Bulletin No. 22 published by Tarion.



SYDNEY 543 (R)

One Bedroom + Den, One Bath
Interior: 543 sq.ft. | Exterior: 100 sq.ft.
Total: 643 sq.ft.

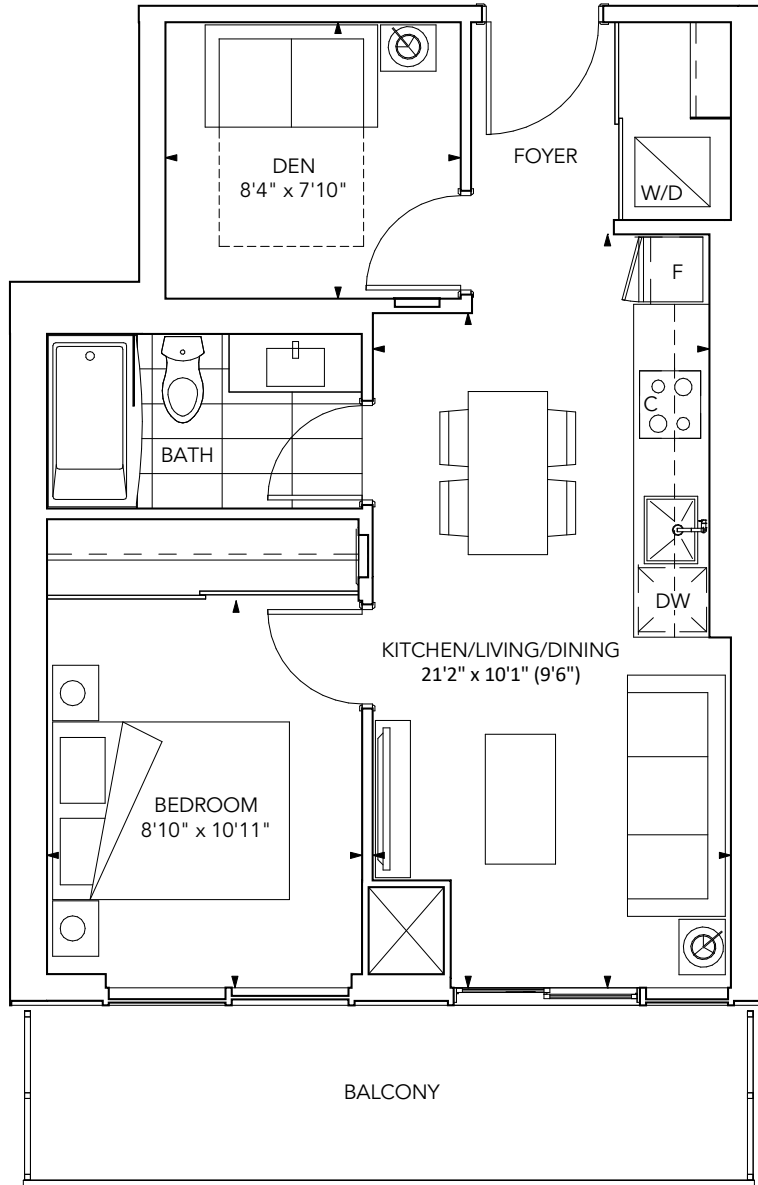

Typical Floor | Tower C

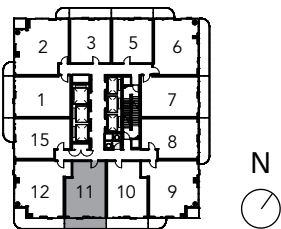

*Prices, sizes and specifications subject to change without notice. E.&O.E. The dimensions shown of this plan are approximate and subject to normal construction variances. Actual useable floor space within the unit may vary from any stated floor areas or dimensions on this plan. Furniture is displayed for illustration purposes only and does not necessarily reflect the electrical plan for the suite. Suites are sold unfurnished. For more information on the method used for calculating the floor area of any unit, reference should be made to Builder Bulletin No. 22 published by Tarion.



SYDNEY 549

One Bedroom + Den, One Bath
Interior: 549 sq.ft. | Exterior: 106 sq.ft.
Total: 655 sq.ft.

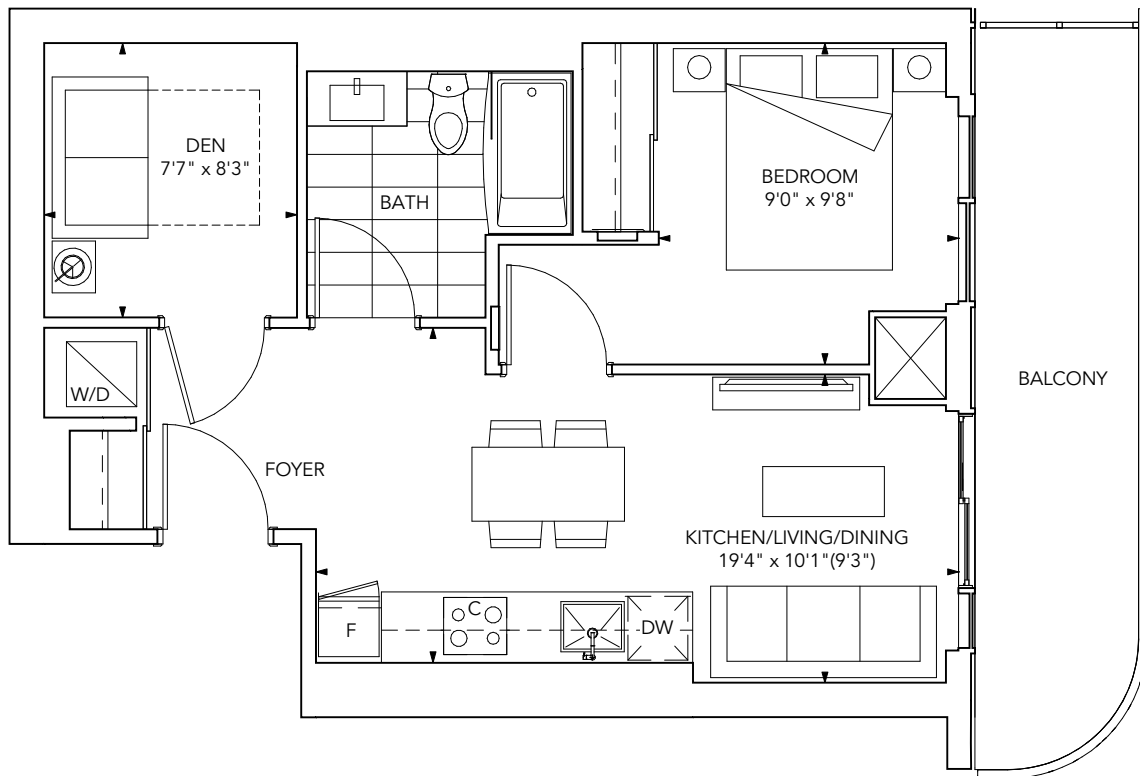

Typical Floor | Tower C

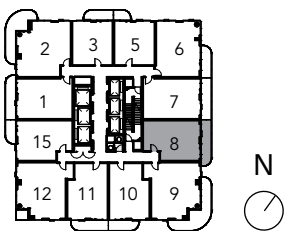

*Prices, sizes and specifications subject to change without notice. E.&O.E. The dimensions shown of this plan are approximate and subject to normal construction variances. Actual useable floor space within the unit may vary from any stated floor areas or dimensions on this plan. Furniture is displayed for illustration purposes only and does not necessarily reflect the electrical plan for the suite. Suites are sold unfurnished. For more information on the method used for calculating the floor area of any unit, reference should be made to Builder Bulletin No. 22 published by Tarion.



NAIROBI 583

One Bedroom + Den, Two Bath

Interior: 583 sq.ft. | Exterior: 100 sq.ft.

Total: 683 sq.ft.

GRAND

FESTIVAL
South VMC

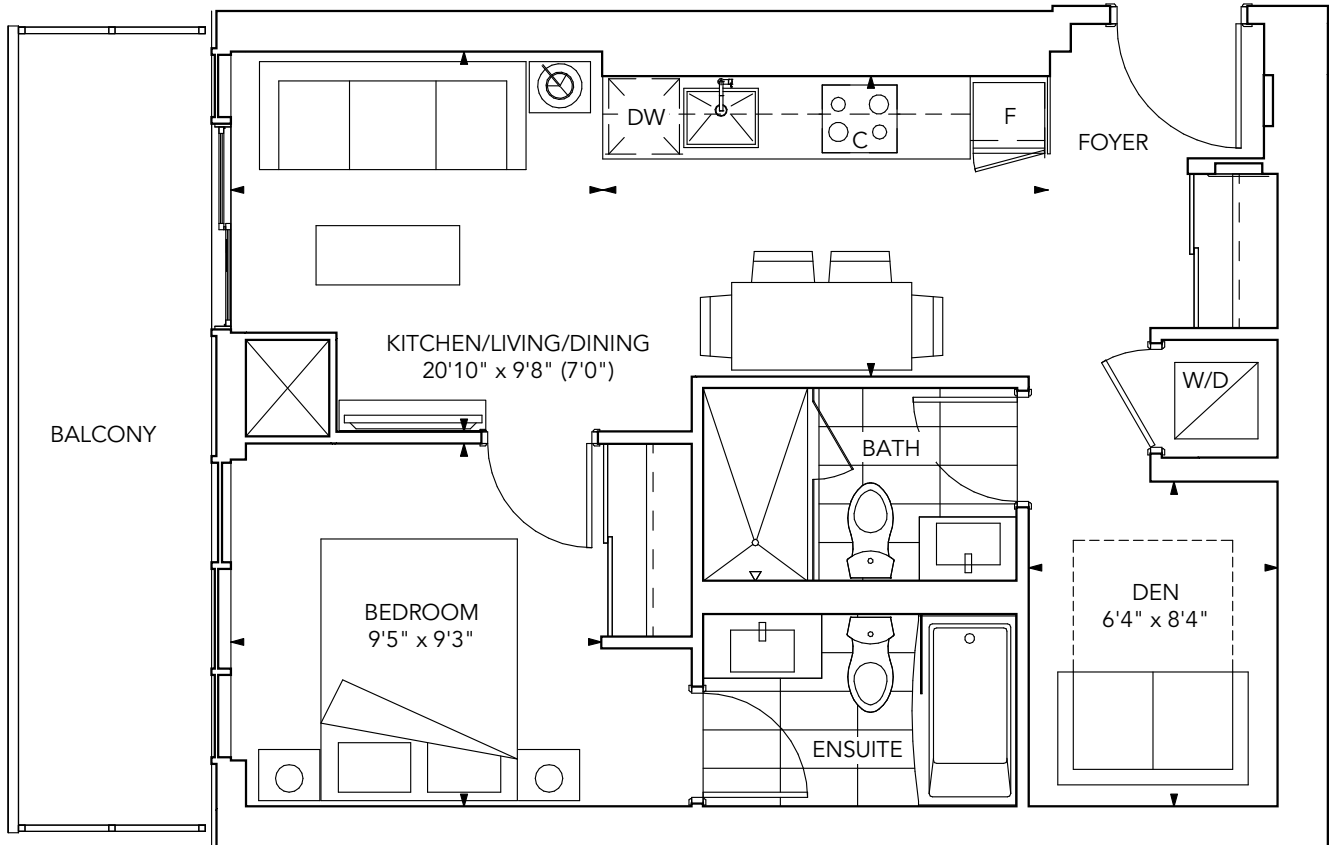

Typical Floor | Tower C

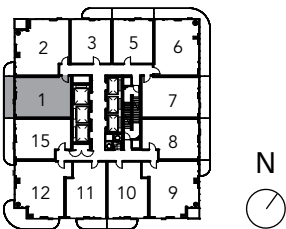

*Prices, sizes and specifications subject to change without notice. E.&O.E. The dimensions shown of this plan are approximate and subject to normal construction variances. Actual useable floor space within the unit may vary from any stated floor areas or dimensions on this plan. Furniture is displayed for illustration purposes only and does not necessarily reflect the electrical plan for the suite. Suites are sold unfurnished. For more information on the method used for calculating the floor area of any unit, reference should be made to Builder Bulletin No. 22 published by Tarion.



NAIROBI 595

One Bedroom + Den, Two Bath
Interior: 595 sq.ft. | Exterior: 100 sq.ft.
Total: 695 sq.ft.

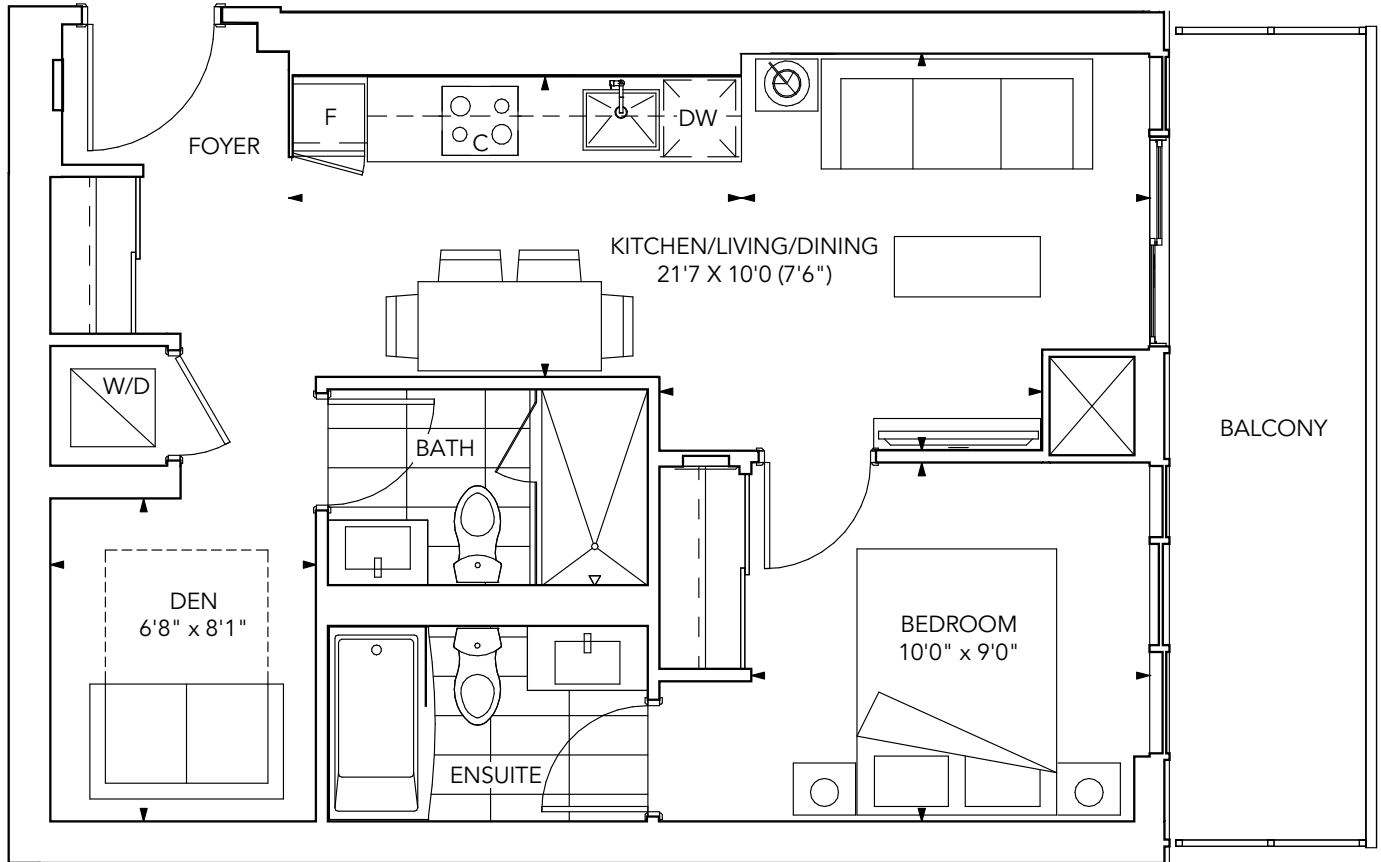

Typical Floor | Tower C

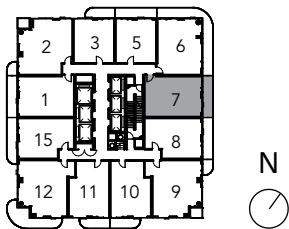

*Prices, sizes and specifications subject to change without notice. E.&O.E. The dimensions shown of this plan are approximate and subject to normal construction variances. Actual useable floor space within the unit may vary from any stated floor areas or dimensions on this plan. Furniture is displayed for illustration purposes only and does not necessarily reflect the electrical plan for the suite. Suites are sold unfurnished. For more information on the method used for calculating the floor area of any unit, reference should be made to Builder Bulletin No. 22 published by Tarion.



NAIROBI 628

One Bedroom + Den, Two Bath

Interior: 628 sq.ft. | Exterior: 250 sq.ft.

Total: 878 sq.ft.

GRAND

FESTIVAL
South VMC

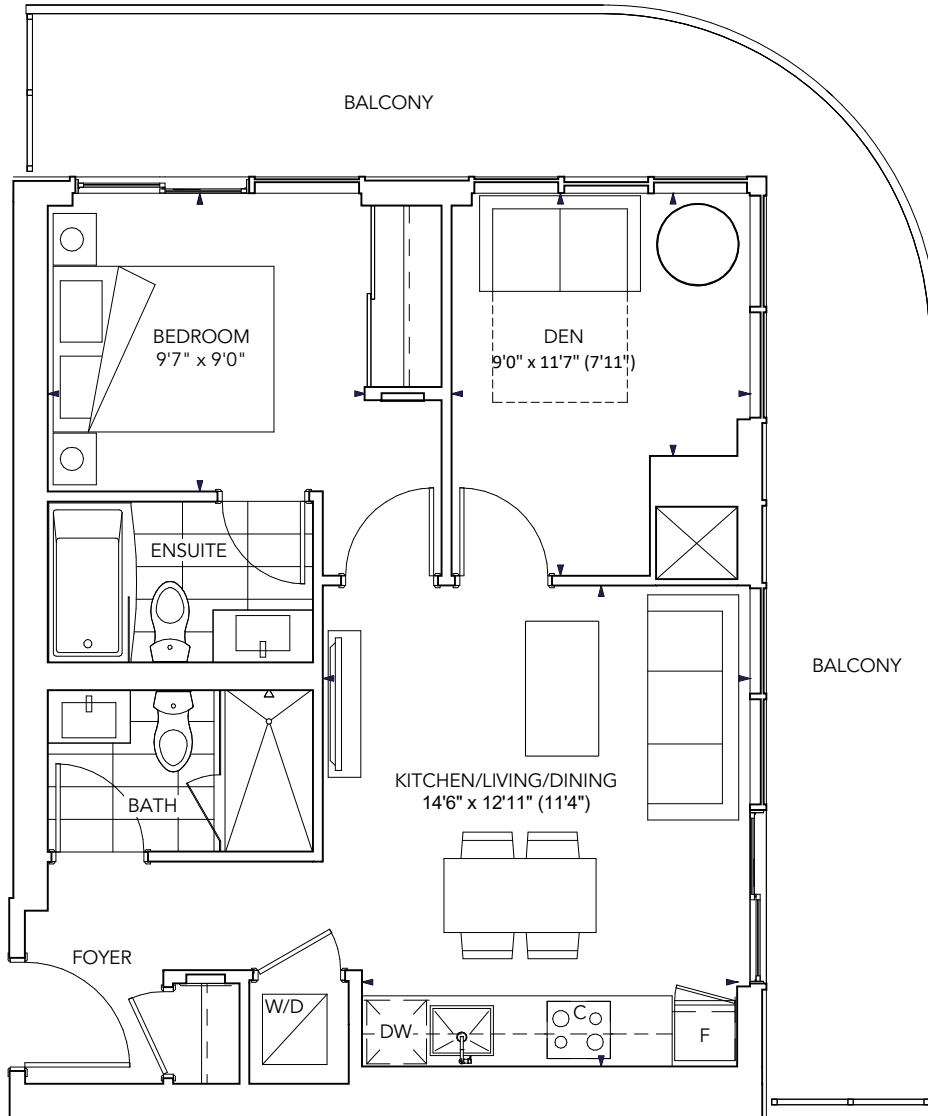

Typical Floor | Tower C

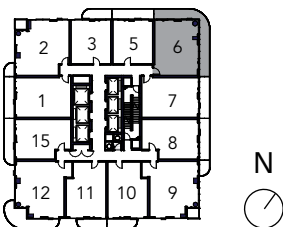

*Prices, sizes and specifications subject to change without notice. E.&O.E. The dimensions shown of this plan are approximate and subject to normal construction variances. Actual useable floor space within the unit may vary from any stated floor areas or dimensions on this plan. Furniture is displayed for illustration purposes only and does not necessarily reflect the electrical plan for the suite. Suites are sold unfurnished. For more information on the method used for calculating the floor area of any unit, reference should be made to Builder Bulletin No. 22 published by Tarion.



SHANGHAI 696

Two Bedroom, Two Bath

Interior: 696 sq.ft. | Exterior: 182 sq.ft.

Total: 878 sq.ft.

GRAND

FESTIVAL
South VMC

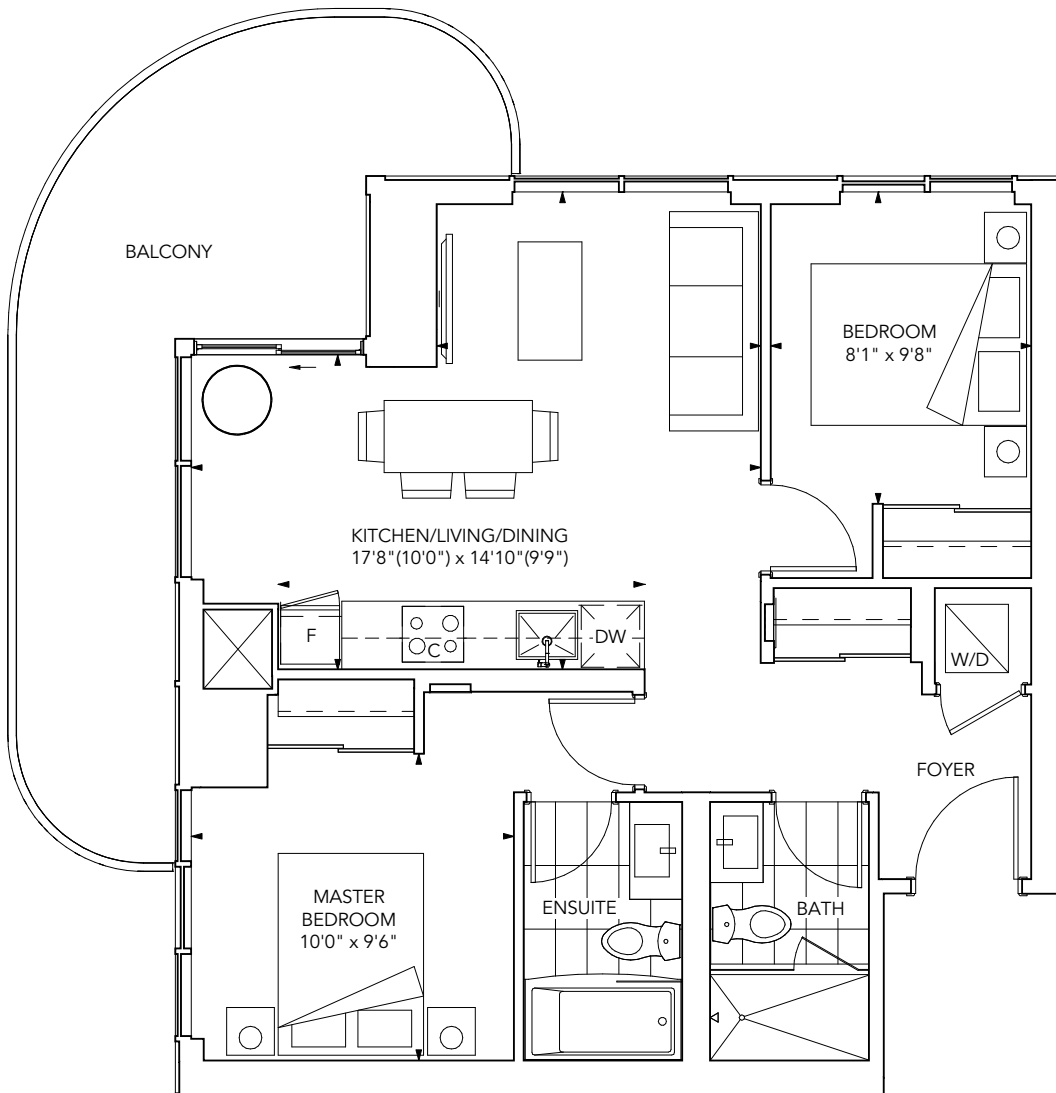

Typical Floor | Tower C

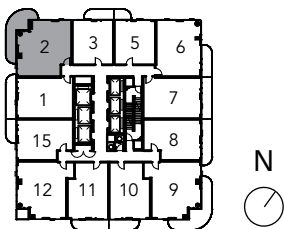

*Prices, sizes and specifications subject to change without notice. E.&O.E. The dimensions shown of this plan are approximate and subject to normal construction variances. Actual useable floor space within the unit may vary from any stated floor areas or dimensions on this plan. Furniture is displayed for illustration purposes only and does not necessarily reflect the electrical plan for the suite. Suites are sold unfurnished. For more information on the method used for calculating the floor area of any unit, reference should be made to Builder Bulletin No. 22 published by Tarion.



SHANGHAI 696

Two Bedroom, Two Bath

Interior: 696 sq.ft. | Exterior: 112 sq.ft.

Total: 808 sq.ft.

GRAND

FESTIVAL
South VMC

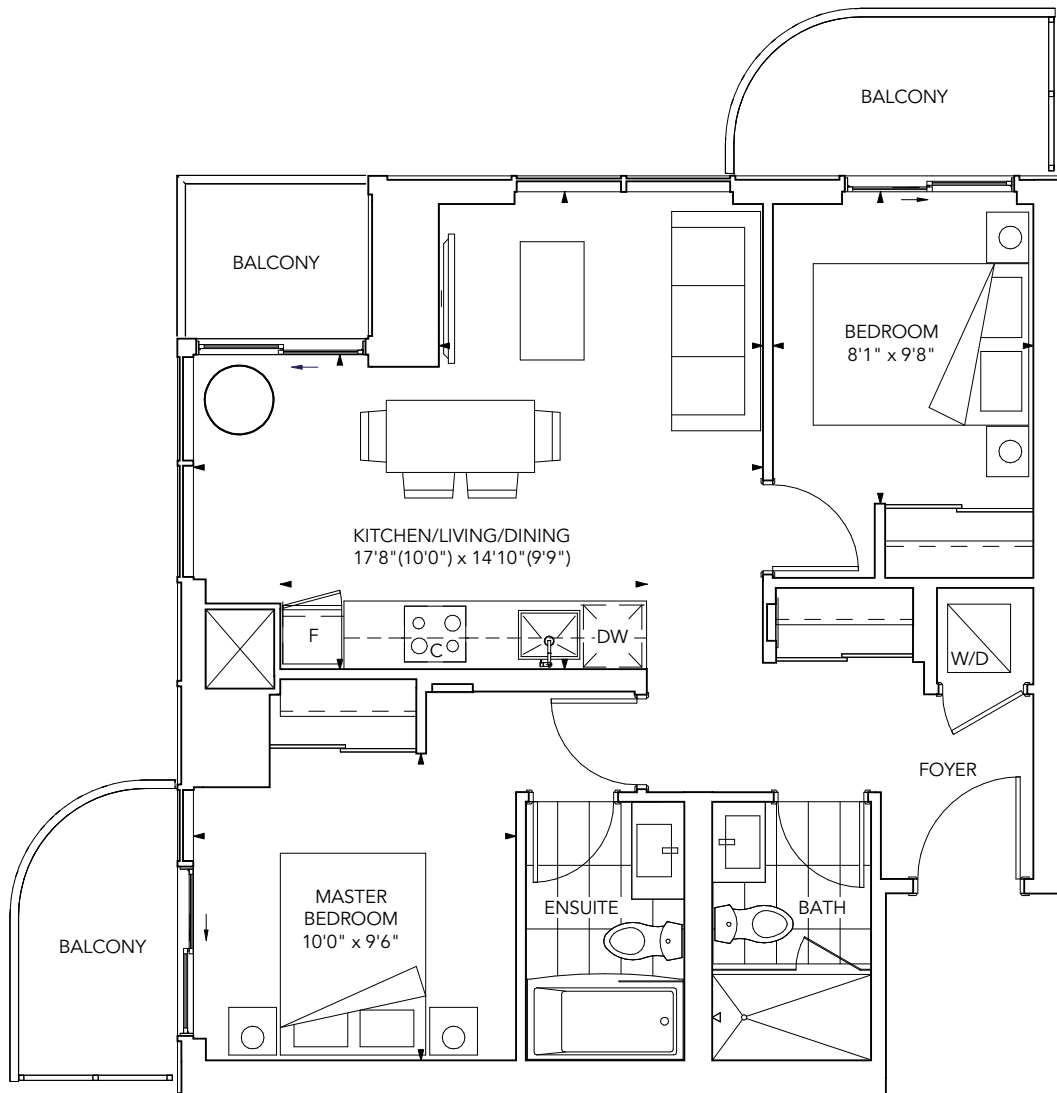

Typical Floor | Tower C

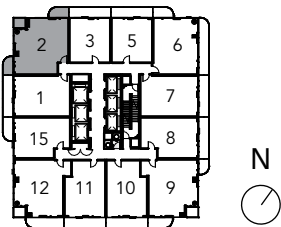

*Prices, sizes and specifications subject to change without notice. E.&O.E. The dimensions shown of this plan are approximate and subject to normal construction variances. Actual useable floor space within the unit may vary from any stated floor areas or dimensions on this plan. Furniture is displayed for illustration purposes only and does not necessarily reflect the electrical plan for the suite. Suites are sold unfurnished. For more information on the method used for calculating the floor area of any unit, reference should be made to Builder Bulletin No. 22 published by Tarion.



SHANGHAI 699

Two Bedroom, Two Bath

Interior: 699 sq.ft. | Exterior: 65 sq.ft.

Total: 764 sq.ft.

GRAND

FESTIVAL
South VMC

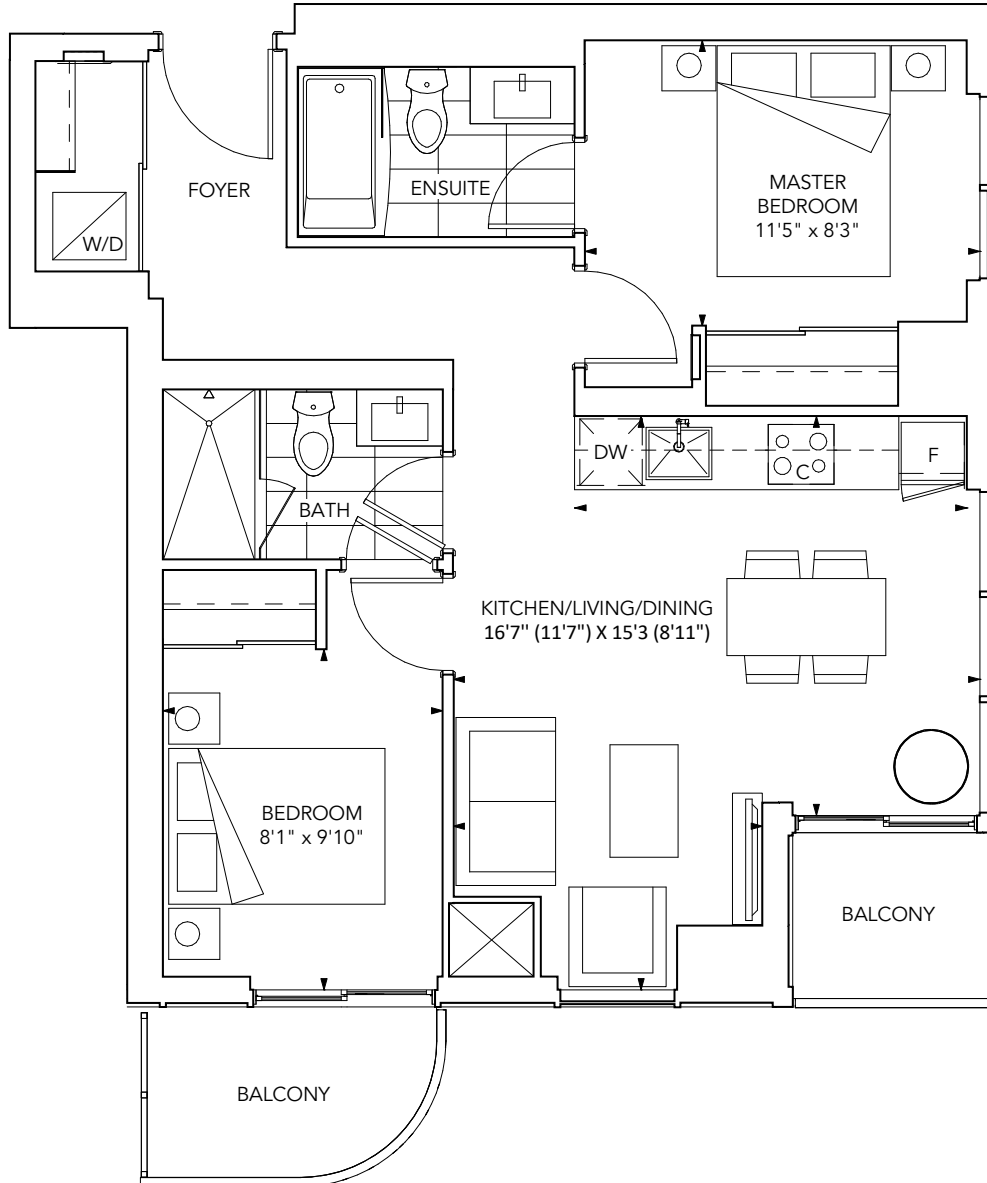

Typical Floor | Tower C

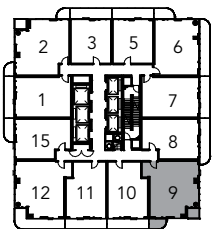

*Prices, sizes and specifications subject to change without notice. E.&O.E. The dimensions shown of this plan are approximate and subject to normal construction variances. Actual useable floor space within the unit may vary from any stated floor areas or dimensions on this plan. Furniture is displayed for illustration purposes only and does not necessarily reflect the electrical plan for the suite. Suites are sold unfurnished. For more information on the method used for calculating the floor area of any unit, reference should be made to Builder Bulletin No. 22 published by Tarion.

