

HILLMONT

AT SXSW





RESORT LIVING ON THE RAVINE

Welcome to Hillmont, the next phase in resort living at the master-planned community of SXSU. Hillmont's two design-forward condominium towers offer spectacular views of the surrounding green parkland. With large balconies that make open-air living effortless and close proximity to trails and green space, you can revel in the freedom to spend as much time as you like outside. In your suite, you'll find luxurious style and an array of elegant, modern features complemented by rich amenities that invigorate your life.



ISLINGTON AVE

HILLMONT
AT SXSW

MEET THE TEAM

Inspired Architecture by

BDP.
Quadrangle

A full-service architecture and interior design firm, BDP. Quadrangle designs the spaces where people live, work and play, with insights gained through listening, exploration, nuanced iteration and quality execution.

Exceptional Landscape Architecture by

NAK 
design strategies

NAK Design Strategies is an award-winning landscape architecture and urban design practice that creates unique and innovative solutions for vibrant public spaces, private oases and community masterplans.

Stunning Modern Design by

FIGUR3

figure3 is a dynamic, award-winning interior design firm that recognizes how design unconsciously influences how people think, feel, decide and behave. At Hillmont, figure3 has designed spaces that draw you in with warmth and beauty.

THE WAY HOME

The new Toronto Subway System Line 1 extension makes it an easy, 45-minute commute from Union Station to Vaughan Metropolitan Centre, and your free SXSU shuttle gets you home from there in minutes.



LEGEND

- █ Line 1 Yonge-University
- █ Line 2 Bloor-Danforth
- █ Line 4 Sheppard
- █ Line 5 Eglinton (LRT)
- ⋯ Free Shuttle Services

SXSU residents benefit from another resort-style exclusive perk: Free shuttle service that takes you directly to Vaughan Metropolitan Centre and to York University. Whatever your destination, accessing it is convenient.

- Station
- Interchange
- ▨ VIA Rail
- ▨ GO Transit

HILLMONT
AT SXSU



L I F E - E N H A N C I N G A M E N I T I E S

From a think space lounge to inspire your creativity to a fitness studio to help you keep in shape and thoughtfully designed social spaces where you can connect with friends and family, the amenities at Hillmont are designed to enhance your life. Every amenity displays a discrete melding of high-tech with design that evokes tranquillity and vitality. No details have been spared in Hillmont's meticulous approach to creating spaces that draw you in and transform your spirit.









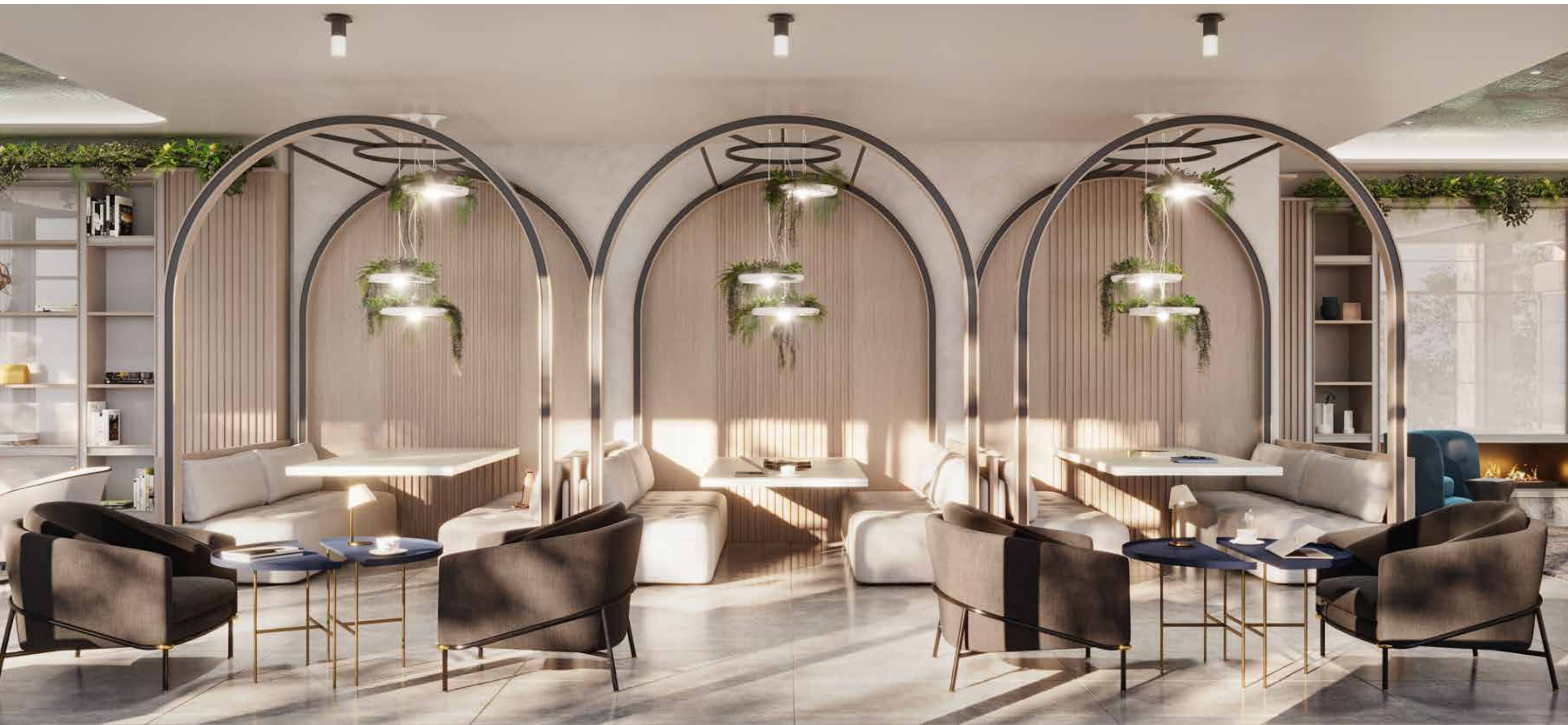



MAIN & 3RD FLOOR AMENITIES

MAIN FLOOR

- 1. LOBBY RECEPTION
- 2. MAIL ROOM
- 3. AUTOMATED LOCKER ROOM
- 4. PARCEL ROOM
- 5. WASHROOMS
- 6. COFFEE BAR
- 7. LOBBY LOUNGE
- 8. MEETING ROOMS
- 9. SOCIAL ROOM
- 10. PROPERTY MANAGEMENT OFFICE
- 11. ZOOM ROOMS
- 12. FIREPLACE LOUNGE
- 13. THINK SPACE LOUNGE
- 14. LIBRARY LOUNGE
- 15. ELEVATORS

3RD FLOOR

- 16. GAMES ROOM



4TH FLOOR AMENITIES



1. PELOTON ROOM
2. YOGA ROOM
3. WASHROOMS
4. GYM
5. LOUNGE
6. ELEVATORS
7. BBQ DINING AREAS
8. SITTING AREAS
9. SPLASH PAD
10. WATER FEATURE

A P A R K D E D I C A T E D T O W E L L - B E I N G

At SXSW, we've prioritized your well-being, dedicating large spaces to fun, games, and play for all ages. A new SXSW community park will provide a plethora of options for recreation and relaxation. Experience the serenity of the ravine lookout, or shoot hoops on the basketball court. There's a kids' play zone for your little ones, with natural hiking trails, and a bocce court for anyone up for friendly competition.



COMMUNITY OVERVIEW

OUTDOOR AMENITIES



- 1. BOCCE COURT
- 2. BASKETBALL COURT
- 3. PING PONG TABLES
- 4. CHESS TABLES
- 5. BIKE RACK
- 6. OUTDOOR DINING
- 7. PLAYGROUND
- 8. LOOKOUT
- 9. WALKING TRAILS



BASKETBALL COURT



BOCCE COURT



PLAYGROUND

Rendering is artist's concept. © 2021 Primont. All Rights Reserved. E.O.& E.

SUITES

STUNNING MODERN DESIGN

The interior design at Hillmont reflects the spectacular natural ravine setting, drawing you in with warmth and beauty. Every suite is a perfect retreat, adorned with stunning modern design by figure3. Featuring clean lines, varying textures, neutral colours and natural materials such as wood, stone and metals, the design is meant to conjure a feeling of comfort, relaxation and tranquillity.





